

## 1 INVENTORY ALL COMPONENTS

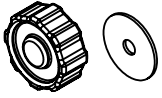

20 Exterior Knob & Rubber Washer  
802011



20 Track End Cap  
802015



20 Interior Knob with Screw  
802013

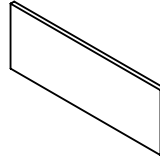

45 2" x 4" Self Adhesive Sections  
of Hook and Loop Velcro



20 Track Receiver  
802012

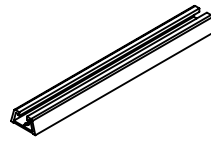

6 Extrusion Track - 12"  
802017



20 1/4-20 x 5/8 Button Socket Screw  
802014

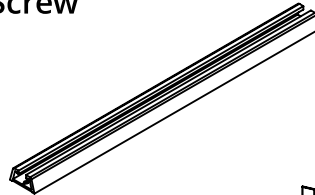

4 Extrusion Track - 19"  
802018

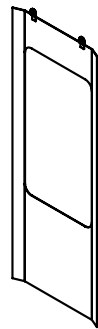
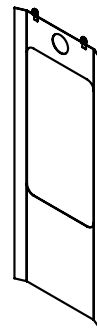
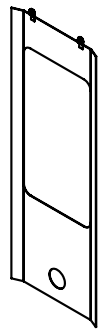
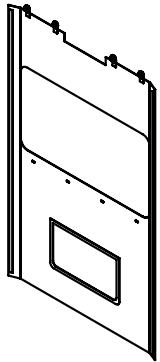

3 Blind Barrier - Large

1 Blind Barrier - Small  
Lower Vent Hole

1 Blind Barrier - Small  
Upper Vent Hole

2 Blind Barrier - Small

## 2 ASSEMBLE TRACK SYSTEM

All tracks require 2 track receivers, 2 interior knobs and 2 end caps

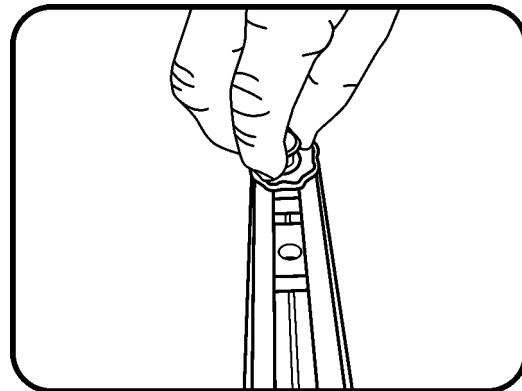
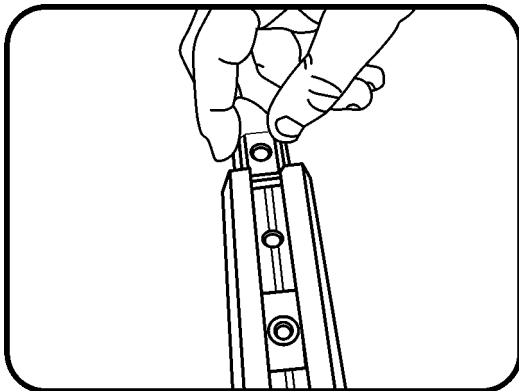

**2a.** To insert end caps, insert widest portion first and rotate up. Window cleaner or other soapy liquid may help with installation.

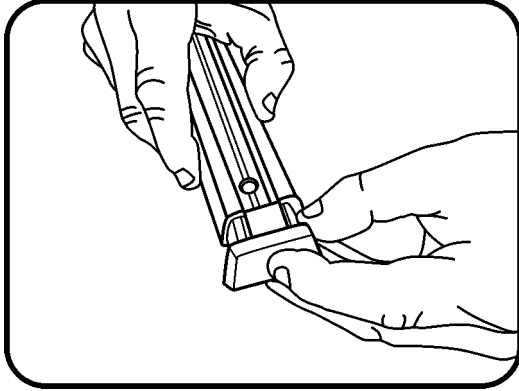

**2b.** Apply rubber washers to the exterior knobs.

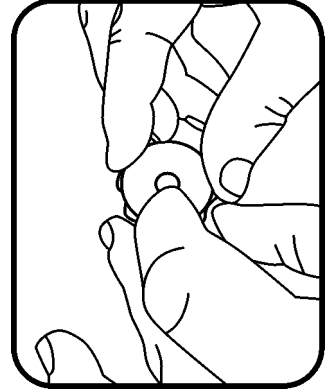
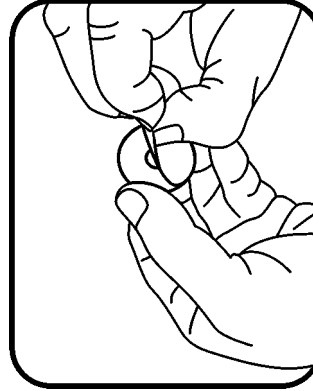

## 3 INSTALL TRACKS

The 19" tracks will be used to hang the small curtains around the vertical windows. 12" tracks will be used to hang the large curtains around the horizontal windows, one on either side of the ozone door area.

**3a.** Holes should be drilled  $1\frac{3}{8}$ " to  $1\frac{1}{2}$ " down from top ledge of blind. Use track for a drilling template. Center in flat space.

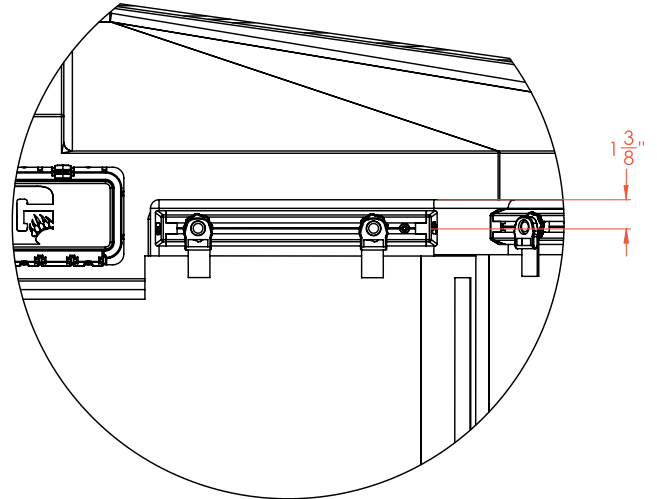

**3b.** Insert  $\frac{1}{4}$ -20 x  $\frac{5}{8}$  button head cap screws in the track and through the blind.

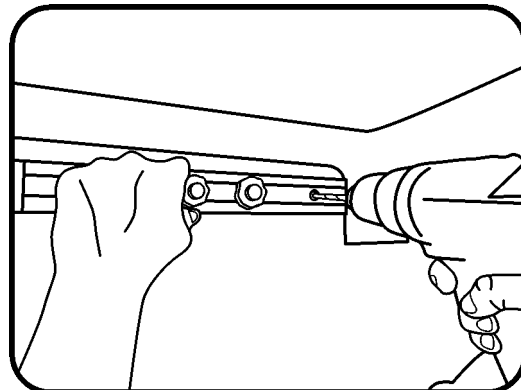
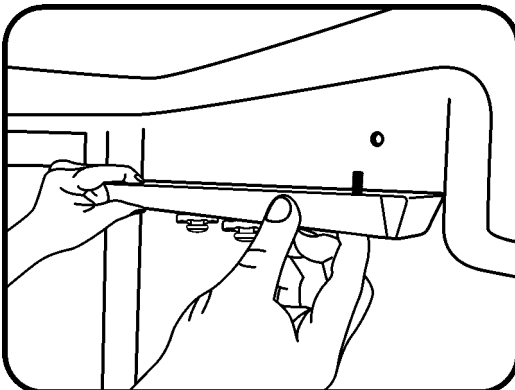

3c. Screw the exterior knobs onto screws. Tighten with 5/32 hex wrench.

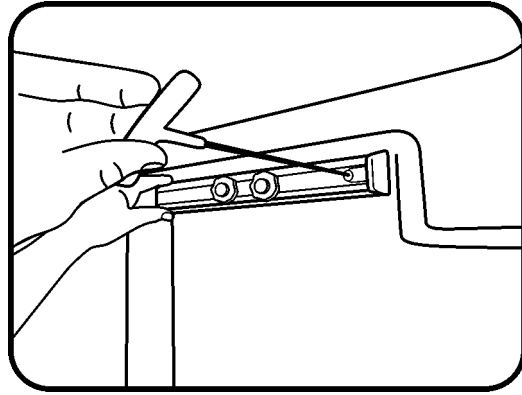
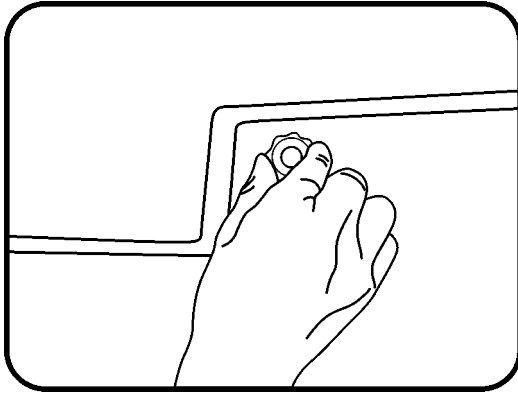

## 4 INSTALL FABRIC COMPONENTS

4a. Install 4" hook side pieces in the shaded locations below. Do not remove the paper backing at this time.

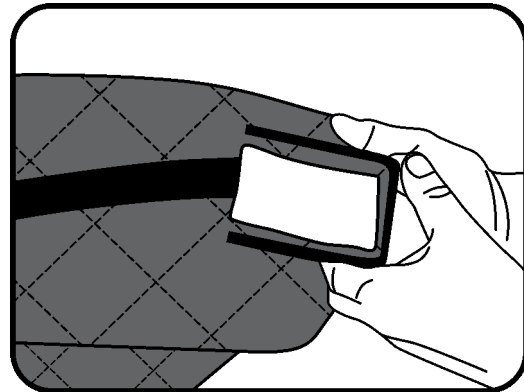
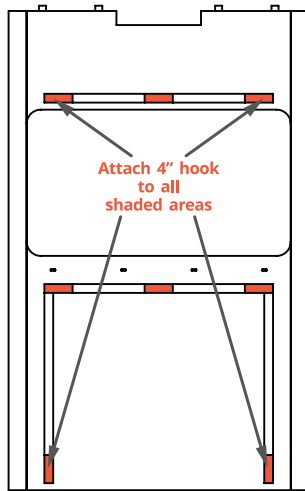
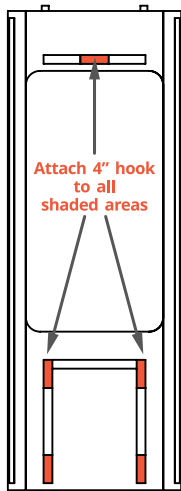

4b. Hang the large curtains first. Use the 1" webbing to adjust the height and level of the curtain. The top of the window opening should end up slightly above the window frame. Some adjustment should be left between the clip and the top of the curtain.

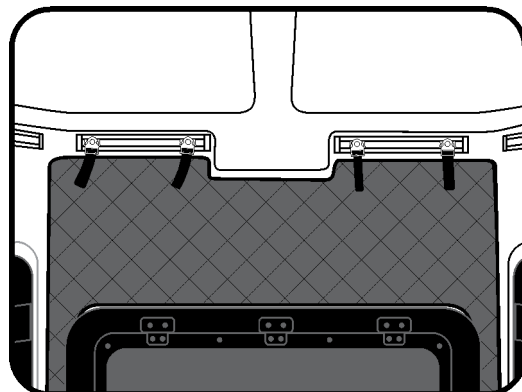
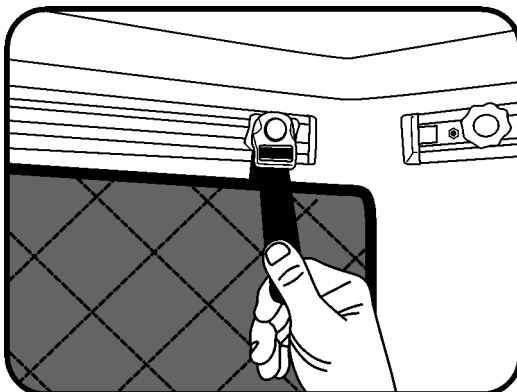

**4c.** Once the curtain is hanging straight, locate the primer packet supplied with the blind kit. In the general area where the hook sections were installed, lightly wipe down the blind wall. Only wipe where the adhesive will attach. Do not over apply, the primer needs to dry before applying adhesive.

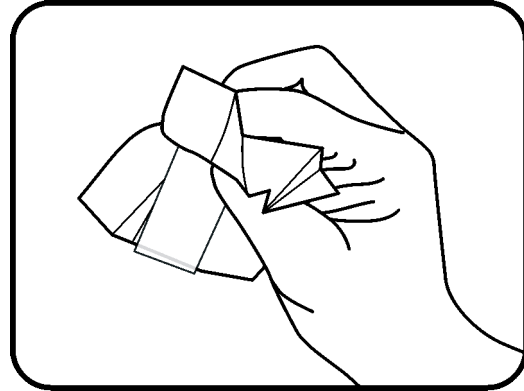
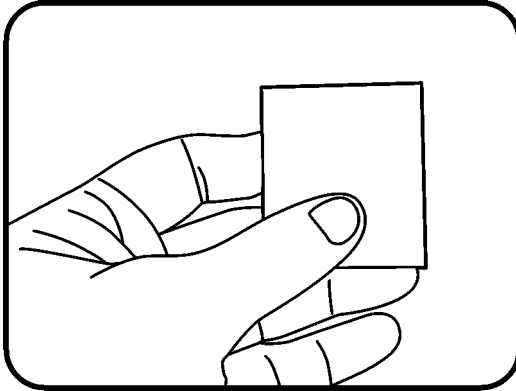

**4d.** Once primer is dry, starting from the top center spot, begin removing paper backing and sticking the hook sections. Work from the center out. Do the same on the bottom half of the curtain. Apply the very bottom location last. Don't worry if you don't get it perfectly straight. Once the adhesive cures you can simply adjust with the hook and loop.

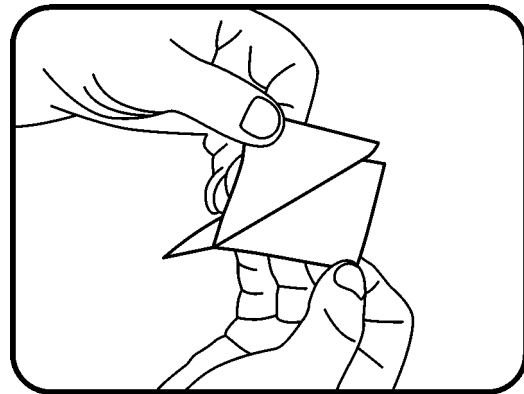

**4e.** Repeat this process for all 3 large curtains.

**4f.** Hang the small curtains.

Use the vertical strips of hook and loop to align the small curtains to the large. Adjust the 1" webbing as necessary.

Repeat steps 4c - 4d for remaining curtains. Ensure you install the small curtains with the vent holes in the correct locations, do not block the blind vents.

Once the adhesive has had an hour to cure adjust the curtains as desired for a neat installation.